

## Grand Drive Raynes Park, SW20 9DJ

£325,000 Leasehold



**This charming 408 sqft ONE BEDROOM, ground floor Victorian Maisonette has its own private entrance to the side of the main house. Superbly located for Raynes Park Station, High Street and access to the A3, An ideal first step onto the property market offering a reception room with space for a dining area, modern separate kitchen and shower room and access to communal parking and gardens. Sold with an extended Lease and No Onward Chain.**

**GRAND DRIVE, SW20**  
 Approx. Gross Internal Floor Area  
 408 Sq. ft/37.93 Sq. m

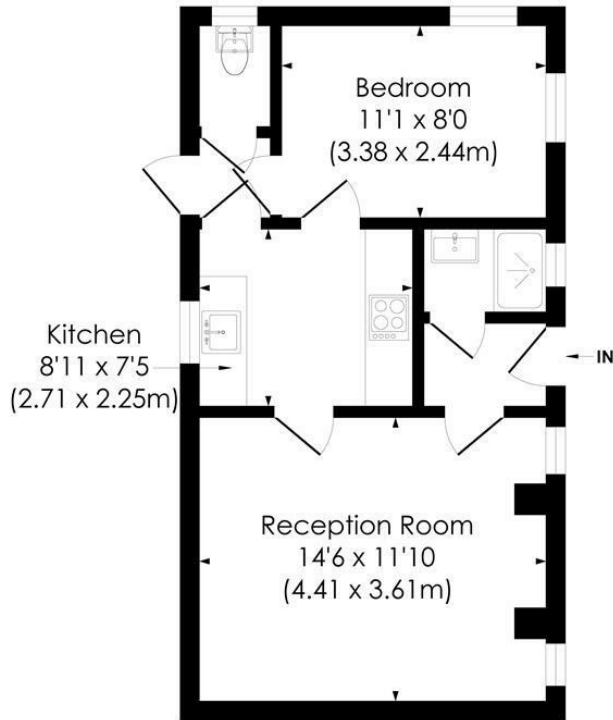

GROUND FLOOR

© Pixangle Property Marketing Ltd. info@pixangle.com Tel: 0208 870 2118



This floor plan has been prepared for the purpose of illustration only in accordance with the latest RICS code of measuring practice and is not to scale. All measurements and areas are approximate and whilst every effort has been made to ensure the accuracy of the plan contained here, no responsibility is taken for any error, omission or misstatement.

- One Double Bedroom - Ground Floor Maisonette
- Extended Lease and No Onward Chain
- Neutrally Decorated Throughout
- Close to Raynes Park Station and High Street
- Communal Parking and Access to Gardens
- Ideal Buy To Let Investment - Estimated Rental of £1,500pcm
- Easy Access to A3 for Routes in and out of London
- Characterful Building
- EPC - D
- Council Tax Band - C

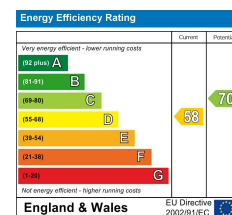

For Free Mortgage Quote and Best Mortgage Rates, call Ellisons Mortgage Advisor on 0208 944 9595



Although these particulars are believed to be correct, their accuracy is not guaranteed and they do not form part of any contract.

Celebrating 30 years  
 of successful Sales and  
 Lettings in Merton

